

# Chapter 3 Staples, Bolt, Bow Eye, U-Bolt, Ring, and Strap

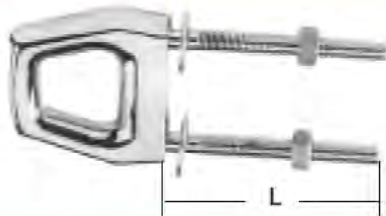

## SINGLE SHACKLE BOW EYE BODY AISI 316

ITEM NO.	L	Thread	Weight/g
005735	3"(75mm)	3/8"	147



## 3" LONG BOW EYE BODY AISI 316

ITEM NO.	L	Thread	Weight/g
005736	3"(75mm)	5/16"	250

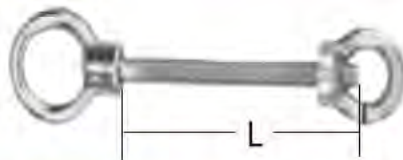

## BOW EYE RING AISI 316

ITEM NO.	Thread	L mm	Weight/g
005800	M6	60	40
005801	M8	80	177
005802	M10	96	290
005803	M12	110	435



## EYE BOLTS AISI 304

one washer welded on thread

ITEM NO.	Thread	L mm	L1 mm	D mm	Weight/g
005236	M6	60(2-5/16")	30(1-3/16")	13	30
005266	M6	95(3-3/4")	60(2-5/16")	13	31
005238	M8	75(3")	35(1-5/16")	15	68
005288	M8	120(4-3/4")	80(3")	15	71
005250	M10	100(4")	50(1-15/16")	19	112
005200	M10	150(6")	100(3-15/16")	19	135



## EYE BOLT AISI 304

with 2 washer and 1 nut

ITEM NO.	Thread	L mm	D mm	Weight/g
005060	M6	60	13	20
005080	M6	80	13	24
005100	M6	100	13	28
005110	M8	110	16	56
005130	M8	130	16	59
005131	M10	130	22	108
005150	M10	150	22	110
005165	M12	165	25	190
005185	M12	185	25	200

# Chapter 3

## Staples, Bolt, Bow Eye, U-Bolt, Ring, and Strap



### RING BOLT AISI 304

ITEM NO.	Ring	d mm	L mm	Weight/g
001806	Φ6x35	M6	80	52
001808	Φ8x45	M8	110	
001810	Φ9x50	M10	130	190
001812	Φ12x60	M12	165	



### RING BOLT with wood screw AISI 316

ITEM NO.	Ring	Thread mm	Weight/g
001813	Φ6x35	6	57
001814	Φ8x45	8	118
001815	Φ9x50	10	192

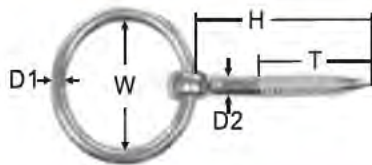

### WOOD SCREW WITH RING AISI 316

ITEM NO.	D1	D2	H	T	W	Weight/g
	mm	mm	mm	mm	mm	
001825	6	6	55	32	30	35
001826	8	8	60	40	50	95
001827	10	10	80	55	60	190



### SCREW EYES AISI 316

Eye with screw thread is ideal for balustade ends into wooden poles and for other applications

ITEM NO.	C	Length	Thread	Length	D	Weight/g
	mm	mm	mm	mm	mm	
001820	6	55	32	6	12	
001821	8	60	40	8	27	
001822	10	80	55	10	47	

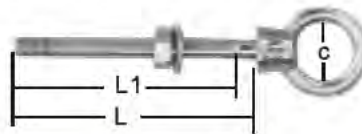

### BOW EYE RING AISI 316

ITEM NO.	Thread	L mm	L1 mm	C mm	Weight/g
005840	M6	40	36	16	30
005860	M6	60	56	16	33
005861	M6	80	76	16	120
005808	M8	80	76	20	69
005810	M8	100	96	20	155
005811	M10	100	96	30	130
005812	M12	120	110	30	240

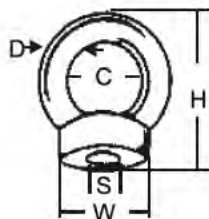

### RING NUT AISI 316

ITEM NO.	S	D	C	W	H	BL/KG	Weight/g
		mm	mm	mm	mm		
004706	M6	6	14	17	27	1500	20
004700	M8	6	14	17	27	1500	20
004701	M8	8	19	22	36		50
004702	M10	8	23	28	36		92
004703	M10	10	23	28	46		92
004704	M12	10	30	34	56	2830	142
004705	M12	12	30	34	56	2830	180

# Chapter 3 Staples, Bolt, Bow Eye, U-Bolt, Ring, and Strap

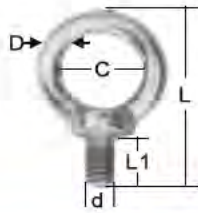

### EYE BOLT AISI 316

ITEM NO.	Size	D	C	d	L1	L	BL/KG	Weight/g
		mm	mm	mm	mm	mm		
<b>004806</b>	6	6	16	M6	14	41	1300	18
<b>004808</b>	8	6.5	20	M8	14	48	1450	30
<b>004810</b>	10	8	23	M10	17	57	2000	58
<b>004812</b>	12	10	30	M12	21	73	2800	105

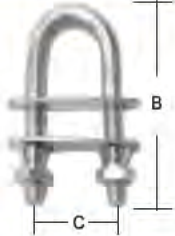

### SECURITY U BOLT WITH INVOLABLE NUTS AISI 316

ITEM NO.	Thread	B mm	C mm	Weight/g
<b>005705</b>	M8	100	40	146
<b>005703</b>	M10	100	40	220
<b>005704</b>	M12	120	47	376



### U BOLTS AISI 316

ITEM NO.	Thread	B mm	L mm	Weight/g
<b>005739</b>	M8	100	40	140
<b>005740</b>	M10	100	40	214
<b>005741</b>	M12	120	47	354



### WATER TIGHT U BOLT AISI 304

White color plastic insert stainless steel plate

ITEM NO.	Thread	Bmm	Cmm	Weight/g
<b>005720</b>	M8	100	35	122
<b>005721</b>	M10	130	50	228
<b>005724</b>	M12	150	65	358

on request AISI 316

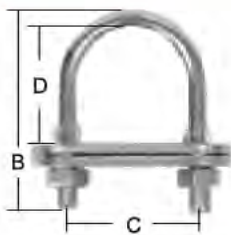

### U BOLTS AISI 304

ITEM NO.	Thread	B mm	C mm	D mm	Weight/g
<b>005706</b>	M5	43	30	25	20
<b>005746</b>	M6	18	33	50	
<b>005742</b>	M6	45	25	40	25
<b>005743</b>	M8	62	45	57	78
<b>005744</b>	M8	88	62	81	106
<b>005745</b>	M8	94	75	87	118

on request AISI 316

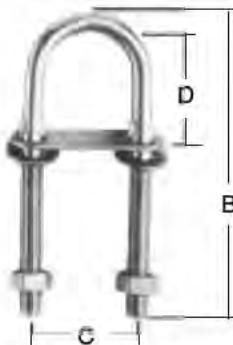

### U BOLTS AISI 304

ITEM NO.	Thread	B mm	C mm	D mm	Weight/g
<b>005715</b>	M4	60	30	30	14
<b>005716</b>	M5	80	35	30	28
<b>005708</b>	M6	80	35	30	38
<b>005717</b>	M8	60	35	40	59
<b>005709</b>	M8	80	35	35	71
<b>005710</b>	M8	100	35	40	83
<b>005718</b>	M8	130	35	40	102
<b>005711</b>	M10	90	50	40	140
<b>005713</b>	M10	130	50	40	174
<b>005714</b>	M12	150	65	65	295

on request AISI 316