

Chapter 2 TurnBuckle, Terminal, Pin, Thimble, and Wire Rope Clamp

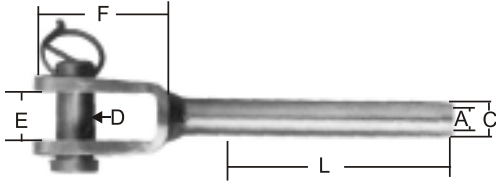

T TERMINAL AISI 316

ITEM NO.	for wire Φ mm	A mm	L mm	Weight/g
005103	3	3.3	80	19
005104	4	4.3	102	46
005105	5	5.3	104	66
005106	6	6.3	132	
005108	8	8.5	176	



FORK TERMINAL AISI 316

ITEM NO.	for wire Φ mm	A mm	L mm	C mm	D mm	E mm	F mm	Weight/g
005303	3	3.3	35	6.3	6	7	17	19
005304	4	4.3	45	7.5	8	9	19	33
005305	5	5.3	50	9.0	10	10	22	57
005306	6	6.3	65	12.7	12	14	29	112
005308	8	8.3	85	16	14	22	43	222

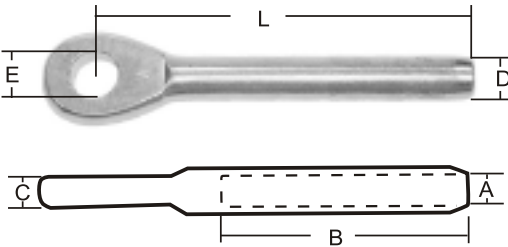

EYE TERMINAL AISI 316

ITEM NO.	for wire Φ mm	A mm	B mm	C mm	D mm	E mm	L mm	Weight/g
005403	3	3.3	35	4.0	6.2	6.5	55	13
005404	4	4.3	40	6.0	8.0	8.5	65	27
005405	5	5.3	55	7.5	9	10.5	80	42
005406	6	6.3	70	9.0	12	12.5	100	156
005408	8	8.5	85	14	16	16	120	



SPLIT RING AISI 304

ITEM NO.	Φ	L mm	Weight/g
000002	2.0	22	0.5
000010	1.5	10	1
000015	1.5	16	2

THREADED SWADGE TERMINAL

with screwed nut AISI 316

ITEM NO.	Thread	for wire Φ mm	A mm	B mm	C mm	L mm	Weight/g
005205	M5 right	2.5	2.5	30	5	90	12
005206	M6 right	3	3.3	35	6.3	97	20
005207	M6 right	4	4.3	45	7.5	110	26
005208	M8 right	4	4.3	45	7.5	115	40
005210	M10 right	5	5.3	50	9.0	128	60
005212	M12 right	6	6.3	65	12.7	162	136
005213	M16 right	8	8.5	75	16	180	240
005216	M5 left	2.5	2.5	30	5	90	12
005217	M6 left	3	3.3	35	6.3	97	20
005218	M6 left	4	4.3	45	7.5	110	26
005219	M8 left	4	4.3	45	7.5	115	36
005220	M10 left	5	5.3	50	9.0	128	63
005221	M12 left	6	6.3	65	12.7	162	136
005222	M16 left	8	8.5	75	16	180	240

